

VSM SIDE MOUNT BRACKETS (FOR RECTANGULAR PLANTERS)

SIDE MOUNT Bracket Installation

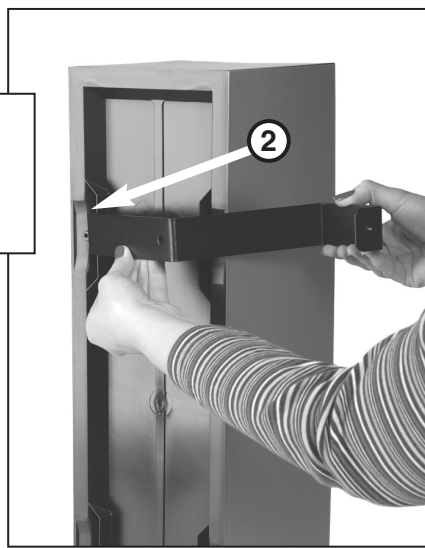

- ① Insert the 1/4-20 set screw as shown.
- ② Place bracket under rectangle and seat end of bracket into rectangle cavity.
- ③ Optional screw can be installed for extra stability.
- ④ Hang planter over the side of partition where desired.

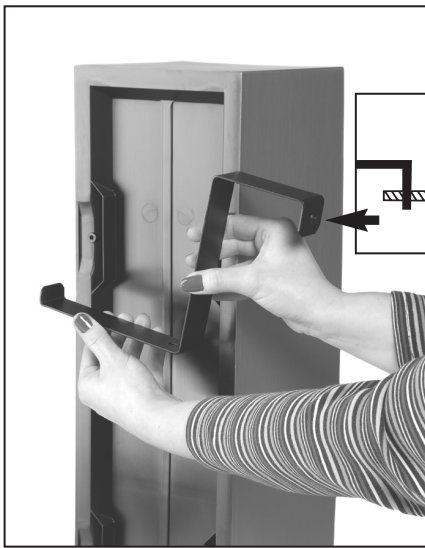
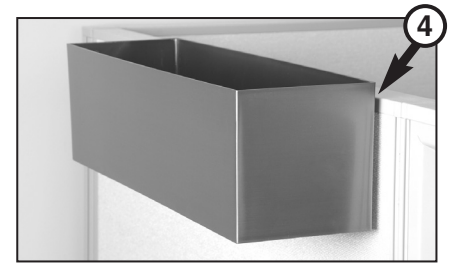

VWM WALL MOUNT BRACKETS (FOR RECTANGULAR PLANTERS)

WALL MOUNT Bracket Installation

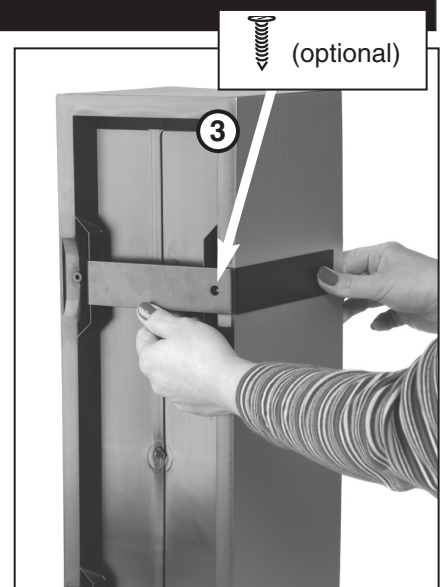
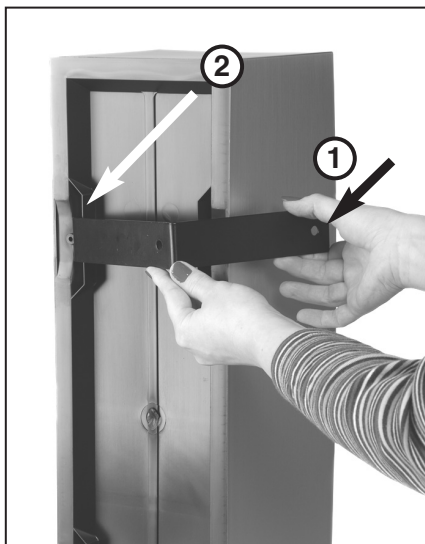

- ① Hole at bracket top used for mounting to wall. Mount bracket to wall first. Suggested wall mounting hardware .
- ② Place bracket under rectangle and seat end of bracket into rectangle cavity.
- ③ Optional screw can be installed for extra stability.

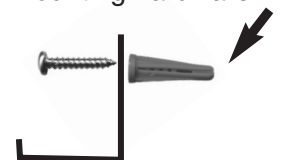

VTM TOP MOUNT BRACKETS (FOR RECTANGULAR PLANTERS)

ASSEMBLE BRACKETS

Three ways to assemble to fit partition widths from 3/4" to 7".

(1) **WIDE** – up to 7" wide

(2) **MEDIUM** width

(3) **NARROW** – as small as 3/4" wide

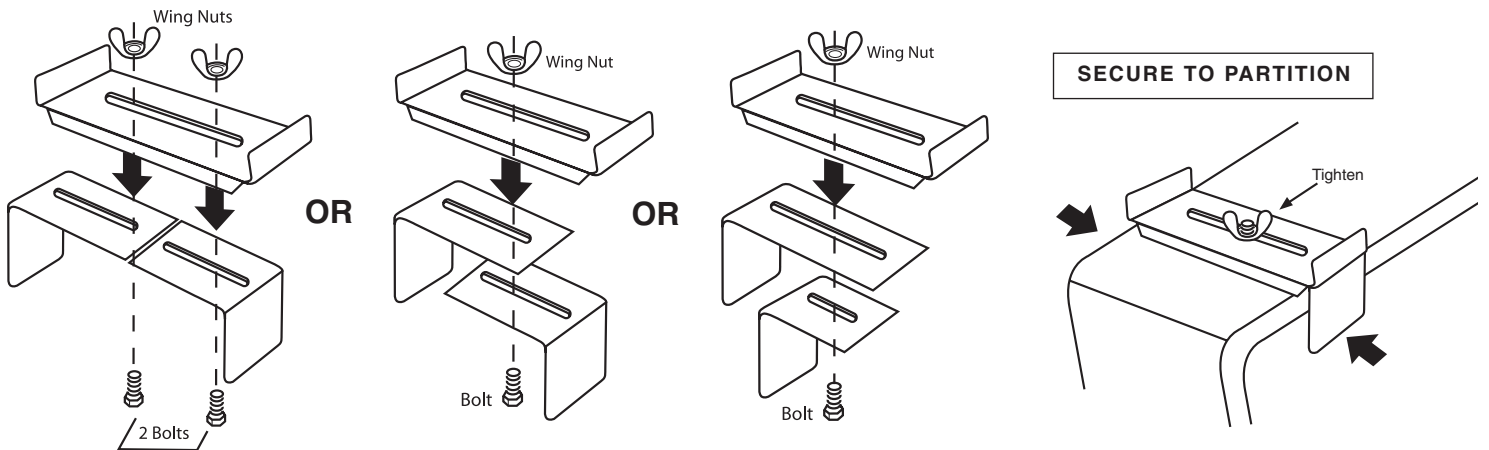

TOP MOUNT Bracket Installation: to bottom of rectangle

